



DIGITAL PORTABLE RADIO

数字手持终端

OWNER'S MANUAL

使用说明书



Preface

Thanks for your favor in our product. This manual is helpful for you to quickly know how to use the product. Please refer to the corresponding Feature Book for detailed features and operations.

This manual is applicable to the following product:
X1e Digital Portable Radio

Instructional Icons



Indicates functions that are available on digital channel only.



Indicates functions that are available on analog channel only.

Functions marked with neither the above icons are available on both analog and digital channels.

Disclaimer

Hytera Communications Co., Ltd. (the Company) endeavors to achieve the accuracy and completeness of this manual, but no warranty of accuracy or reliability is given. All the specifications and designs are subject to change without notice due to continuous technology development. No part of this manual may be copied, modified, translated, or distributed in any manner without the express written permission of us.

We do not guarantee, for any particular purpose, the accuracy, validity, timeliness, legitimacy or completeness of the Third Party products and contents involved in this manual.

If you have any suggestions or would like to learn more details, please visit our website at: <http://www.hytera.com>.

RF Radiation Information

This product must be restricted to operations in an occupational/controlled RF exposure environment. Users must be fully aware of the hazards of the exposure and able to exercise control over their RF exposure to qualify for the higher exposure limits.

RF Radiation Profile

Radio Frequency (RF) is a frequency of electromagnetic radiation in the range at which radio signals are transmitted. RF technology is widely used in communication, medicine, food processing and other fields. It may generate radiation during use.

RF Radiation Safety

In order to ensure user health, experts from relevant industries including science, engineering, medicine and health work with international organizations to develop standards for safe exposure to RF radiation. These standards consist of:

- United States Federal Communications Commission, Code of Federal Regulations; 47CFR part 2 sub-part J;
- American National Standards Institute (ANSI)/ Institute of Electrical and Electronic Engineers (IEEE) C95. 1-1992;
- Institute of Electrical and Electronic Engineers (IEEE) C95.1-1999;
- International Commission on Non-Ionizing Radiation Protection (ICNIRP) 1998.

FCC Regulations

Federal Communication Commission (FCC) requires that all radio communication products should meet the requirements set forth in the above standards before they can be marketed in the U.S, and the manufacturer shall post a RF label on the product to inform users of operational instructions, so as to enhance their occupational health against exposure to RF energy.

Operational Instructions and Training Guidelines



To ensure optimal performance and compliance with the occupational/controlled environment RF energy exposure limits in the above standards and guidelines, users should transmit not more than 50% of the time and always adhere to the following procedures:

RF energy will be generated only when the radio is transmitting.

EU Regulatory Conformance

As certified by the qualified laboratory, the product is in compliance with the essential requirements and other relevant provisions of the Directive 1999/5/EC. Please note that the above information is applicable to EU countries only.

Contents

Items in the Package	2
Product Overview	2
Product Control	2
Programmable Keys	2
Before Use	2
Charging the Battery	2
Attaching the Battery	3
Checking the Battery Power	3
Attaching the Antenna	3
Attaching the Accessories	3
Status Indication	3
LED Indicator	3
Basic Operation	4
Powering On/Off	4
Adjusting the Volume	4
Selecting a Zone	4
Selecting a Channel	4
Call Services	4
Private Call 	4
Group Call 	4
Call on Analog Channel (No Signaling) 	4
Emergency Call	5
Troubleshooting	5
Care and Cleaning	6
Optional Accessories	6

Items in the Package

Please unpack carefully and check that all items listed below are received. If any item is missing or damaged, please contact your dealer.

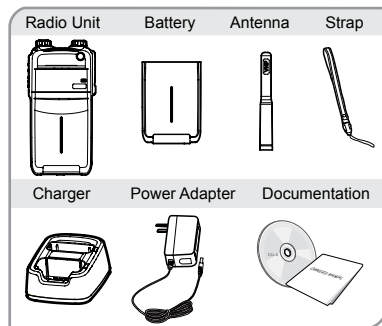

Note: The frequency band is marked on the label of antenna; if not, please refer to the label on the radio for frequency band information.

Product Overview

Product Control

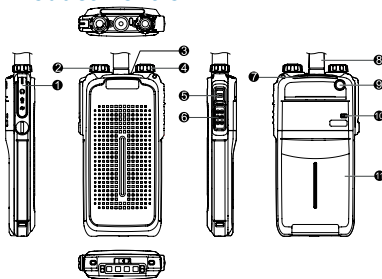

No.	Part Name	No.	Part Name
1	Accessory Connector	7	Speaker
2	Power On-Off/Volume Control Knob	8	Antenna
3	LED Indicator	9	TK (Top Key)
4	Channel Selector Knob	10	Microphone
5	SK (Side Key)	11	Battery
6	PTT (Push to Talk) Key	/	/

Programmable Keys

For enhanced convenience, you may request your dealer to program the **TK** (Ⓚ) and **SK** as shortcuts to certain functions. Please refer to the corresponding Feature Book for more details.



Caution: The **TK** is programmed with emergency feature by default (short press: Emergency On; long press: Emergency Off). It is programmable by your dealer.

Before Use

Charging the Battery



Caution:

- Make sure the radio is powered off before charging. Read the Safety Information Booklet in advance to get necessary safety information.
- To achieve optimal battery performance, please charge the battery for at least 3.5 hours before initial use.

Please use the charger specified by the Company to charge the battery. Charging Diagram is listed below.

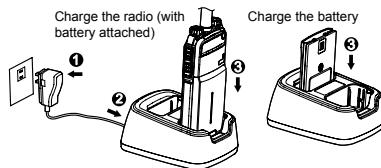

Charging Status Indication (on charger):

LED Indication	Charging Status
The LED Indicator flashes red slowly.	Standby (no load)
The LED Indicator glows red.	Charging
The LED Indicator glows orange.	90% charged
The LED Indicator glows green.	Fully charged
The LED Indicator flashes red rapidly.	Charging failed

Attaching the Battery

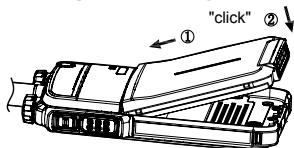

To remove the battery, turn off the radio first. Then slide the lock as ① shows to release the battery latch, and take out the battery as ② shows.

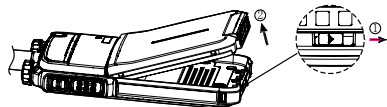

Checking the Battery Power

You may check the current battery power by holding down the programmed **Battery Power Indicator** key preset by your dealer. And release the key to exit. Battery power indications are listed below:

LED Indication	Battery Power
The LED Indicator glows green.	High
The LED Indicator glows orange.	Medium
The LED Indicator glows red.	Low
The LED Indicator glows red and low battery alert beeps.	Under the low battery threshold. Please recharge or replace the battery for proper radio operation

Attaching the Antenna



Caution: Do not hold the radio by its antenna, otherwise the performance and lifespan of the antenna will be reduced.

Attaching the Accessories

Caution: Please attach the accessory properly; otherwise, waterproof performance of the radio may get affected.

1. Loosen the screw on the accessory connector cover to uncover the connector.
2. Align the accessory plug with the connector.
3. Tighten the screw on the accessory plug.

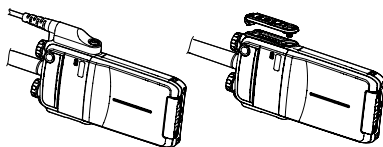

Status Indication

LED Indicator

LED Indication	Radio Status
The LED indicator flashes green.	Powering on
The LED indicator glows green.	Receiving
The LED indicator glows red.	Transmitting
The LED indicator flashes orange slowly.	Scanning or roaming
The LED indicator flashes orange rapidly.	Emergency
The LED indicator glows orange.	Call hung. During a call, you can hold down the PTT key to talk to the other party before the call hang time expires.
The LED indicator glows blue and then flashes once every three seconds.	The LED indicator glowing blue indicates the BT feature is being started; the LED indicator flashing blue once every three seconds indicates the BT feature is enabled, but no Bluetooth device is connected.
The LED indicator flashes once every two seconds.	Bluetooth device is connected.

Basic Operation

Powering On/Off

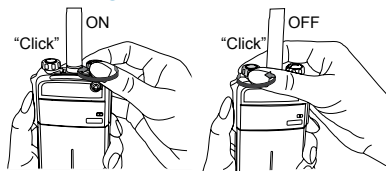

Adjusting the Volume

You can adjust the volume of output voice, alert tone and channel notification tone by rotating the **Volume Control Knob**. For other tones, the volume will be configured by the dealer.

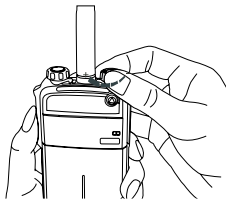

Selecting a Zone

A zone is a group of channels exhibiting the same property, which is programmed by your dealer and can facilitate convenient management over the channel. The radio supports 3 zones, each of which consists of up to 16 channels. You can switch to the

appropriate zone by pressing the programmed **Zone Up** or **Zone Down** key preset by your dealer.

Selecting a Channel



If the Channel Notify feature is enabled by your dealer, the radio will announce the channel number upon channel switching.

Call Services

After the radio is powered on, you can make and receive calls. To ensure optimal volume of the receiving radio, keep the microphone about 2.5 to 5 centimeters away from your mouth when transmitting.

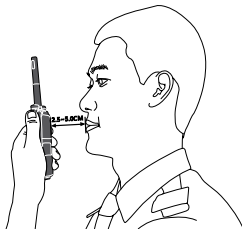

Private Call

Initiating a Private Call

In the standby mode, hold down the **PTT** key to initiate a Private Call to the Private Call contact preset for the current channel. You may request your dealer to preset a regular Private Call contact, Group Call contact or an All Call contact for each digital channel.

Receiving and Responding to a Private Call

When a Private Call is received, you can listen to it without any operation, and you may hold down the **PTT** key within the preset time period to call back.

Group Call

Initiating a Group Call

In the standby mode, hold down the **PTT** key to initiate a Group Call to the Group Call contact preset for the current channel.

Receiving and Responding to a Group Call

When a Group Call is received, you can listen to it without any operation, and you may hold down the **PTT** key within the preset time period to call back.

Call on Analog Channel (No Signaling)

To transmit on an analog channel, hold down the **PTT** key and speak into the microphone. To receive, release the **PTT** key.

Please refer to the corresponding Feature Book for operation description on how to make and receive calls on the analog channel with signaling.

Emergency Call

In case of emergency, you can use this feature to ask for help from your companion or the control center. The Emergency Call has the highest priority which can terminate the ongoing calls with lower priorities on the current channel. You can make an emergency call even when your radio is transmitting or receiving. This feature needs to be configured and enabled by your dealer. Please refer to the corresponding Feature Book for details.

Troubleshooting

Phenomena	Analysis	Solution
The radio fails to power on.	The battery may be improperly installed.	Remove the battery and then reattach it.
	The battery power may be used up.	Recharge or replace the battery.
	The battery may be poorly connected due to dirtied or damaged battery contacts.	Clean the battery contacts. If the problem cannot be solved, contact your dealer or authorized service center for inspection and repair.
During receiving, the voice is weak, discontinuous or totally inactive.	The battery voltage may be low.	Recharge or replace the battery.
	The volume level may be low.	Increase the volume by rotating the Volume Control Knob .
	The antenna may be loosened or improperly installed.	Reattach the antenna after turning off the radio.
	The speaker may be blocked or damaged.	Clean the surface of the speaker. If the problem cannot be solved, contact your dealer or authorized service center for inspection and repair.
You cannot communicate with other members.	The frequency or signaling may not match that of other members.	Set your TX/RX frequency and signaling to the same as that of other members.
	The channel type (digital/analog) may be set inconsistently.	Make sure all members are on the same digital/analog channel.
	You may be too far away from the group members.	Move towards other members.
Irrelevant communication or noise is heard on the channel.	You may be interrupted by radios using the same frequency.	Change the frequency, or adjust the squelch level.
	The radio may be set with no signaling.	Set signaling for all member radios to avoid interference at the same frequency.

Phenomena	Analysis	Solution
The noise is too loud.	You may be too far away from other members.	Move towards other members.
	You may locate in an unfavorable position. For example, your communication may be blocked by high buildings or frustrated in the underground areas.	Move to an open and flat area, and restart the radio to try again.
	You may suffer from external disturbance (such as electromagnetic interference).	Stay away from equipment that may cause interference.
GPS positioning fails.	GPS signals may not be received due to unfavorable position.	Move to an open and flat area to try again.
Bluetooth device cannot be paired.	The battery power of Bluetooth device may be low.	Recharge the Bluetooth device.
	Bluetooth device may be too far away from the radio.	Move the Bluetooth device towards the radio.

If the above solutions cannot fix your problems, or you may have some other queries, please contact us or your local dealer for more technical support.

Care and Cleaning

To guarantee optimal performance as well as a long service life of the product, please follow the tips below.

Product Care

- Do not pierce or scrape the product.
- Keep the product far away from corrosive environments.
- Do not hold the product by its antenna or earpiece cable directly.
- Attach the accessory connector cover when the accessory is not in use.

Product Cleaning



Caution: Turn off the product and remove the battery before cleaning.

- Clean up the dust and fine particles on the product surface and charging piece with a clean and dry lint-free cloth or a brush regularly.
- Use neutral cleanser and a non-woven fabric to clean the keys, control knobs and front case after long-time use. Do not use chemical preparations such as stain removers, alcohol, sprays or oil preparations, so as to avoid surface case damage.
- Make sure the product is completely dry before use.

Optional Accessories

The following items are the main optional accessories for the radio. For more information of other accessories, please consult your local dealer.



Caution: Use the accessories specified by the Company only. If not, the Company shall not be liable for any loss or damage arising out of use of unauthorized accessories.

- Power Supply: BL1103 Li-Ion Battery (1100mAh), BL1809 Li-Ion Battery (1800mAh), CH04L01 Portable Charger, CHV09 Vehicle Adapter for Charger, MCA05-X Battery Optimizing System (X1e series), POA53 Li-ion Battery Adapter for X1e series.
- Audio: EAN19 3-wire Surveillance Earpiece with Transparent Acoustic Tube (Beige), EAN21 3-wire Surveillance Earpiece with Transparent Acoustic Tube (Beige), EAN22 Detachable Earpiece with Transparent Acoustic Tube, EHN20 Remote Swivel Earset, EHN21 Remote C-Earset, EHW02 Wireless Earpiece With Dual-PTT, ESN14 Remote Earbud, EWN07 Digital Wireless Covert Earpiece With in-Line Controller (Neckloop Sensor), EWN08 Digital Wireless Covert Earpiece (Flatpack Sensor), POA47 Bluetooth Ring PTT
- Cable: PC45 Programming Cable (USB Port)
- Carry Accessories: NCN009 Covert Shoulder Harness, PCN005 Belt Clip



致用户

非常感谢您对我们产品的青睐！本手册旨在让您快速掌握本产品的使用，如需了解产品详细功能和操作，请参考《功能手册》。

本手册适用于以下机型：

X1e 数字手持终端

图标说明



：表示数字信道独有的功能，只能在数字信道上使用。



：表示模拟信道独有的功能，只能在模拟信道上使用。

未用图标区分的功能在数字信道和模拟信道上都可使用。

免责声明

本手册在编制过程中力求内容的准确性与完整性，但对于可能出现的错误或疏漏，我司不承担任何责任。由于技术的不断发展，我司保留不予通知而更改产品设计与规格的权利。未经我司事先书面授权，不得以任何形式对本手册进行复制、修改、翻译和散发。

本手册中涉及的第三方产品和内容归第三方所有，我司对其准确性、有效性、及时性、合法性或完整性均不提供保证。

如需更多信息或对本手册有任何建议，欢迎访问我们的网站：<http://www.hytera.com>，或拨打我司服务热线：400-830-7020。

射频辐射信息

本产品仅限于能够满足射频能量辐射要求的职业应用。使用者必须清楚了解射频辐射危害并可采取相应措施，满足射频辐射限定要求。

射频辐射常识

射频指可以辐射到空间的电磁频率，是通讯、医疗、食品加工等领域广泛使用的一种技术，在使用过程中会产生一定的射频辐射。

射频辐射安全

为了确保用户的身心健康，来自科学、工程、医药、

健康和工业的专家们与相关组织共同研究制定了射频辐射标准和准则，如下所示：

- 美国联邦通信委员会联邦政府法规汇编第 47 卷第 2 部分 J 子部分。
- 美国国家标准协会 (ANSI)/ 电气和电子工程师协会 (IEEE) 标准 C95.1-1992 版。
- 电气和电子工程师协会标准 C95.1-1999 版。
- 国际非电离辐射防护委员会 (ICNIRP) 于 1998 年颁布的标准。

美国联邦通信委员会监管要求

按照美国联邦通信委员会的监管要求，本产品必须符合美国联邦通信委员会射频辐射限制规定，否则不能在美国市场上销售。并要求制造商可通过在产品上张贴标签的方式，告知用户应注意的事项，提高用户的防辐射意识。

射频辐射控制及操作说明

为了使产品发挥最佳性能及确保符合上述标准中有关职业或受控环境中的辐射限制要求，发送时间不得超过额定因数的 50%（最高 50% 的时间发射），且需遵照下列说明：

仅在发射（讲话）时产生射频能量辐射，接收（收听）和待机时均不会产生。

欧盟指令符合性声明

本产品经独立第三方机构认证，符合欧盟指令“1999/5/EC”中的相关要求。

请注意，本声明仅适合欧盟国家。

目录

包装清单	2
熟悉本产品	2
部件介绍	2
可编程键	2
用前准备	2
充电	2
安装电池	2
查看电量	3
安装天线	3
安装附件	3
状态指示	3
LED 指示灯	3
基本操作	3
开机与关机	3
调节音量	3
选择区域	3
选择信道	4
呼叫	4
个呼 	4
组呼 	4
模拟信道呼叫（无信令） 	4
紧急报警	4
故障处理	5
保养与清洁	5
选购配件	6
保修范围与期限	6

包装清单

包装盒内含有以下物品。如有任何物品丢失或损坏，请与您所购产品的经销商联系。



备注: 天线频段请参考天线底部色环标签内容。若标签未注明频段，则参考主机标签上的具体频段。

熟悉本产品

部件介绍

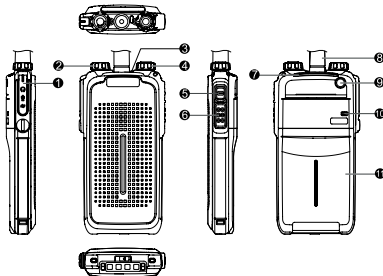

编号	部件名称	编号	部件名称
1	附件接口	7	扬声器
2	电源开关 / 音量控制旋钮	8	天线
3	LED 指示灯	9	TK (顶部键)
4	信道选择旋钮	10	麦克风
5	SK1 (侧键)	11	电池
6	PTT 键 (发射键)	/	/

可编程键

为了提升操作便利性，本产品提供 2 个可编程键：TK (▲) 和 SK1。可由您的经销商编程为功能快捷键，详情请咨询您的经销商。各功能的详细介绍您可以参考对应的“功能手册”。



注意: 【TK】键出厂时设置短按为“紧急报警开启”快捷键，长按为“紧急报警关闭”快捷键。

用前准备

充电



注意:

- 为整机充电时，建议关闭本产品，并提前参阅《安全信息手册》，以获取必要的电池安全信息。
- 为获得最佳电池性能，首次充电时，请至少充电 3.5 小时。

请使用我司指定的充电座充电。充电示意图如下图所示。

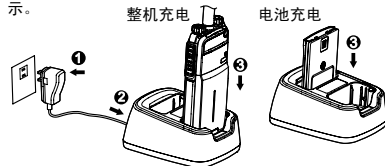

充电座指示灯显示充电状态：

指示灯显示	当前充电状态
红色 LED 慢闪	待机 (空载)
红色 LED 长亮	正在充电
橙色 LED 长亮	电池已充满 90% 的电量
绿色 LED 长亮	电池已经充满
红色 LED 快闪	充电过程中出现故障

安装电池

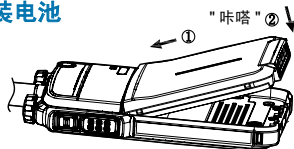

如需卸下电池，请先关闭本产品。按下图示①的箭头方向拨动卡扣以松开电池推钮，然后将底部电池推钮往上提起（如下图②）并取出电池。

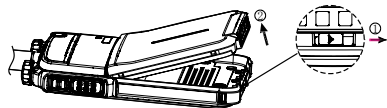

查看电量

如果经销商为本产品设置了【电池电量提示】快捷键，您可以通过按住该快捷键查看电池的当前剩余电量。松开该按键即可退出。

LED 提示	电池电量
绿灯亮	电量高
橙灯亮	电量中
红灯亮	电量低
红灯亮 + 低电提示音	电量不足，达到低电阈值，请尽快充电或者更换电池，以确保本产品保持正常工作。

安装天线



注意：请勿手持天线顶端甩动本产品，否则会降低本产品天线的工作性能和使用寿命。

安装附件



注意：请正确安装附件，否则本产品的防水性能可能会受到影响。

1. 松开附件接口上的螺钉，打开附件接口。。
2. 将附件插头对准附件接口。
3. 将附件插头上的螺钉拧紧。

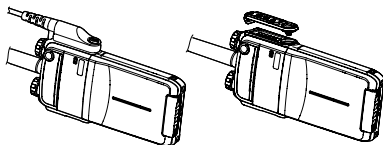

状态指示

LED 指示灯

指示灯状态	产品状态
绿灯闪烁	正在开机
绿灯长亮	正在接收
红灯长亮	正在发送
橙灯慢闪	正在扫描或者漫游
橙灯快闪	紧急状态
橙灯长亮	呼叫建立成功，在橙灯长亮期间您可以按住【PTT】键进行回呼
蓝灯长亮后每 3 秒闪烁一次	蓝灯长亮表示正在开启蓝牙功能，蓝灯每 3 秒闪烁一次表示已成功开启蓝牙功能，但未连接蓝牙设备
蓝灯每 2 秒闪烁一次	已连接蓝牙设备

基本操作

开机与关机



调节音量

调节输出语音、呼叫提醒提示音和信道播报的音量，其他提示音的音量由经销商设置。

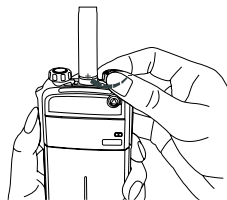

选择区域

区域是一个信道组，您可以将具有相同属性的信道列入一个区域中，这样便于您对现有信道进行有效管理。本产品支持 3 个区域，每个区域最多包含 16 个信道。若经销商为您设置了【区域上调】/【区域下调】快捷键，您可通过按此快捷键可切换至所需区域。

选择信道

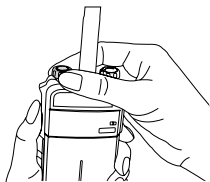

如果经销商为本产品开启了信道播报功能，此处切换信道时本产品将播报信道号。

呼叫

开机成功后，您可以进行各种呼叫操作。为了保证接收方最佳接收音量，发射时请保持麦克风距离嘴大约 2.5 ~ 5 厘米。



个呼

发起个呼

在待机界面下，按住【PTT】键即可对当前数字信道上预设的个呼联系人直接发起呼叫。

您可通过经销商为每个数字信道预设一个“发射联系人”，该联系人可以是个呼联系人，也可以是组呼或全呼联系人。

接听和回复个呼

接收到个呼后，您无需任何操作即可接听，在预设时间内按住【PTT】键可发送回呼。

组呼

发起组呼

在待机状态下，按住【PTT】即可对当前数字信道上预设的组呼联系人发起组呼。

接听和回复组呼

接收到组呼后，您无需任何操作即可接听，在预设时间内按住【PTT】可发送回呼。

模拟信道呼叫（无信令）

在模拟信道上，如需发射，请按住【PTT】键并对着麦克风讲话。如需接收，请松开【PTT】键。

使用信令发起呼叫的操作方法请参见本产品配套的“功能手册”。

紧急报警

遇到紧急情况时，您可通过此功能来向同伴或控制中心寻求帮助。紧急报警有最高优先权，可打断当前正在进行的任何普通呼叫。无论对讲机处于发射或接收状态，您都可进行报警。

紧急报警功能需由经销商为您配置和开启，详见本产品对应的“功能手册”。

故障处理

故障描述	原因分析	解决方法
无法开机	电池可能未正确安装	取出电池并重新装入。
	电池电量可能已经耗尽	充电或更换电池。
	电池触点污浊或受损而导致接触不良	清洁电池触点。如仍不能解决问题，请联系经销商或我司指定维修点进行检修。
接收信号时声音小、断续或无声	电池电压过低	充电或更换电池。
	音量较小	通过【音量控制】旋钮调大音量。
	天线松动或安装不到位	关机后重新安装天线。
	扬声器堵塞或受损	进行简单的外部清洁。如仍不能解决问题，请联系经销商或我司指定维修点进行检修。
无法与组内其他成员通话	所用频率或信令设置与组内其他成员不同	设置与组内其他成员相同的频率和信令。
	数字、模拟信道设置不当	设置相同的数字信道或模拟信道。
	距离组内其他成员太远	尽量靠近其他成员，确认位于其有效通讯范围之内。
信道中出现其他通话声或杂音	受到同频用户的干扰	更改为新的频点，或调整静噪级别。
	未设置信令	对组内所有对讲机进行信令设置，以防止同频干扰。但必须同时更改组内所有手持终端的信令设置。
噪声较大	与其他成员之间的通讯距离过远	靠近其他成员。
	所处位置不佳，如受高大建筑物阻挡，或位于地下室等	移至开阔平坦地后，开机重试。
	受外界环境或电磁干扰	避开可能引起干扰的设备。
GPS 无法定位	所处位置不佳，以致接收不到 GPS 信号	移至开阔平坦地后重试。
蓝牙设备无法配对	蓝牙设备电量不足	为蓝牙设备充电。
	蓝牙设备与本产品距离太远	将蓝牙设备移近本产品。

如上述方法仍未解决您的问题，或您遇到一些其他的故障，请联系当地经销商或我司以获取更多的技术支持。

保养与清洁

为了保证本产品发挥其良好性能，以及延长其使用寿命，请熟悉以下内容，以便更好地对本产品进行日常保养与清洁。

保养

- 请勿用硬物穿刺或刮花本产品。
- 请勿将本产品存放于含有腐蚀电子电路物质的环境。
- 携带或使用本产品过程中，请勿用手提天线或耳机线。
- 当不使用附件时，请盖好附件接口盖。

清洁



注意：清洁之前，请关机并取出电池。

- 请定期使用洁净干燥的无绒布或毛刷拭去本产品表面及充电极片附着的粉尘。
- 本产品的按键、控制旋钮和机壳极易变脏。可用中性洗涤剂和无纺布对其进行清洁，请勿用去污剂、酒精、喷雾剂或石油制剂等化学药剂进行清洁，以避免产品表面和外壳受损。
- 清洁之后，务必保证本产品彻底干燥，否则请勿使用。

选购配件

本产品主要的选购附件已包含在如下列表中，如需更多附件信息，请咨询您当地的经销商或拨打我司服务热线 400-830-7020。



注意：请使用我司指定的配件。若擅自使用未经许可的配件，则由此所导致的一切后果，由用户自行负责。

- 电源类：BL1103 锂离子电池（1100mAh）、BL1809 锂离子电池（1800mAh）、CH04L01 便携式充电器、CHV09 座充车载电源适配器、MCA05-X 电池分析仪、POA53 锂电适配器
- 音频类：EAN19 三线透明管双 PTT 线控耳机（米色）、EAN21 三线透明管监控耳机（米色）、EAN22 分体式透明管耳机、EHN20 分体可调节耳挂式耳机、EHN21 分体 C 型耳挂式耳机、EHW02 无线耳机、ESN14 分体耳塞式耳机、EWN07 无线线控数字隐形耳机（项圈式感应器）、EWN08 无线数字隐形耳机（扁平式感应器）、POA47 无线指环 PTT
- 线材类：PC45 编程连接线（USB 口）
- 携带类：NCN009 隐藏式背心、PCN005 携带夹

保修范围与期限

我司承诺，凡我司生产的产品，自购买之日起，在正常使用、操作与维护条件下，出现材料或制造工艺方面的缺陷，可享受以下规定的保修服务。

主机	24 个月
标配附件（包括电池、充电座）	12 个月



is the trademark or registered trademark of Hytera Communications Corp., Ltd.
© 2014 Hytera Corp., Ltd. All Rights Reserved.

Address: HYT Tower, Hi-Tech Industrial Park North, Beihuan
RD., Nanshan District, Shenzhen, China
Postcode: 518057
<http://www.hytera.com>



是海能达通信股份有限公司的商标或注册商标
© 2014 Hytera Corp., Ltd. 版权所有

地址: 深圳市南山区北环大道9108号
邮编: 518057
服务热线: 400-830-7020
<http://www.hytera.com>

Z07639 C10524 L07157



81100X1100600